

1 2 3 4 5 6 7 8 9 10 11 12 13 14 15

A
B
C
D
E
F
G
H
I
J
K

DEVELOPMENT SUMMARY

LOT AREA: (2.32 AC) 100899 SF
 FOOTPRINT/GROUND LEVEL AREA: 20261 SF
 SECOND LEVEL AREA: 19526 SF
 TOTAL GROSS BUILDING AREA: 39787 SF
 TOTAL RESIDENTIAL UNIT COUNT: 94 UNITS (ALL STUDIO UNITS)
 STANDARD PARKING STALLS: 106 STALLS
 ADA PARKING STALLS: 7 STALLS
 TOTAL PARKING STALLS: 113 STALLS

PROPERTY DETAILS

STREET ADDRESS:
 130 NORTH 2100 WEST
 SALT LAKE CITY, UT 84116
 PROPERTY LEGAL DESCRIPTION:
 BEG ON N LINE OF N TEMPLE ST AT A PT N
 89°58'30" E 1959.03 FT & N 0°00'35" W 804 FT FR S
 1/4 COR SEC 33, T1N, R1W, SLB & M, SD PT
 BEING N 89°58'38" E 676.32 FT & N 0°00'35" W
 155.28 FT FR SALT LAKE CITY MON AT
 INTERSECTION OF 2200 W & N TEMPLE ST; N
 0°00'35" W 331.12 FT; N 89°59'25" E 343.34 FT; S
 0°00'35" E 145.55 FT; S 89°54'56" W 50 FT; S
 0°07'27" W 144.25 FT; W 119.25 FT; S 41.30 FT; W
 173.75 FT TO BEG. 2.28 AC M OR L. 4879-0966
 7325-1939 7348-1522,1524 8804-89869206-5127
 9465-271 9487-3173 10243-7377

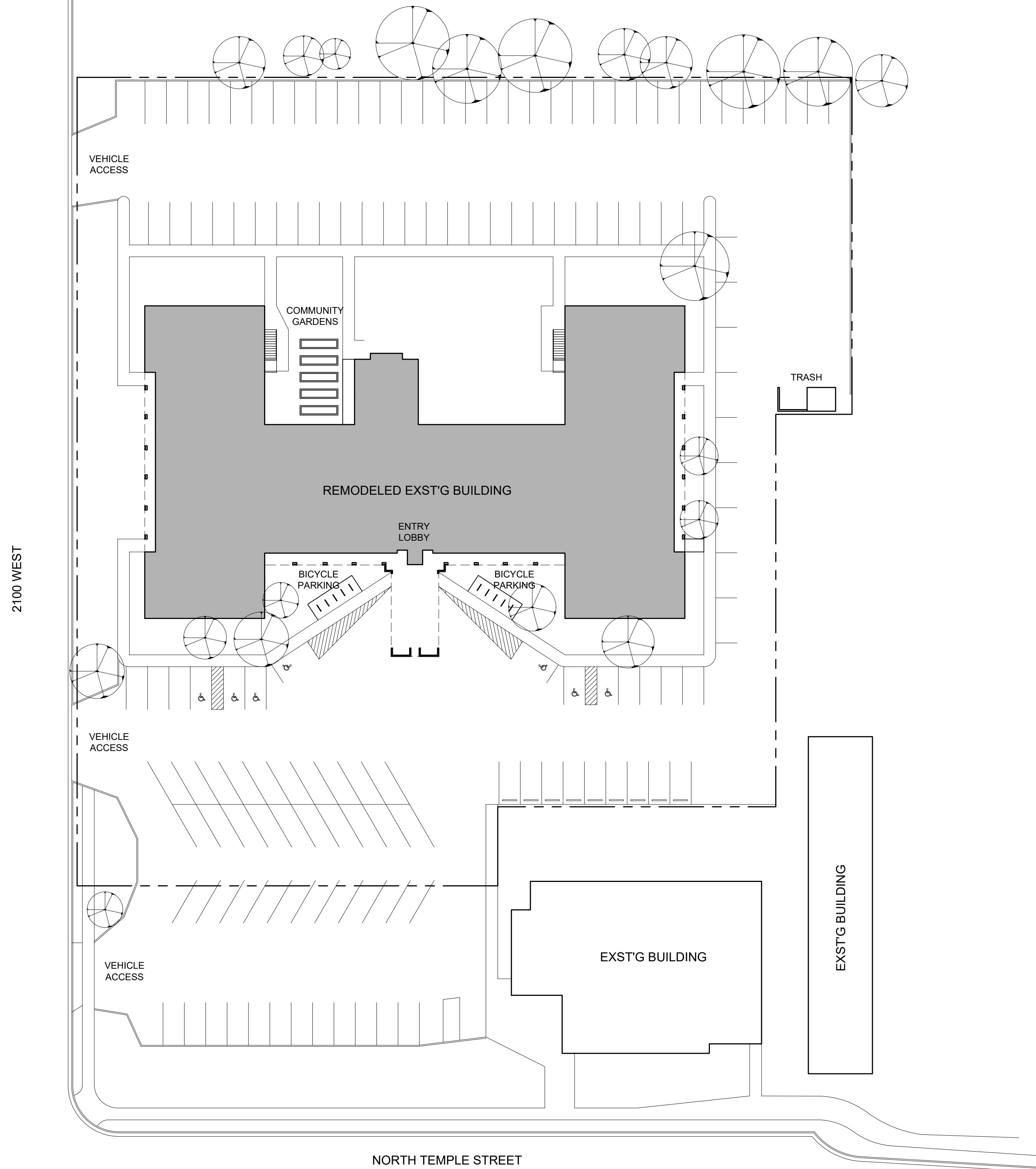

The Point
 Fairpark

SWITCHPOINT COMMUNITY
 RESOURCE CENTER
 948 NORTH 1300 WEST
 ST GEORGE, UT 84770

assist
 COMMUNITY DESIGN CENTER

Tel: 801.355.7085 | TTY: 711
 218 East 500 South | Salt Lake City, UT 84111 | www.assistutah.org

NOT FOR
 CONSTRUCTION

Revision	Date

Project No: 22003
 Date: 08.18.2022
 COPYRIGHT 2022
 ASSIST Community Design Center

Site Plan

C1.1

K1 Proposed Site Plan
 C1.1 1" = 30'-0"

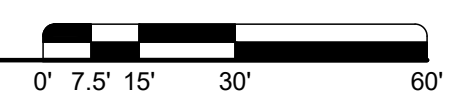

1 2 3 4 5 6 7 8 9 10 11 12 13 14 15